

# YOU FRAME IT

mix&match bar system

# YOU FRAME IT

mix&match bar system

# YOU NAME IT

## YOU FRAME



The **You Frame It** mix and match bar system gives you freedom to frame almost any material at any size.

Each **You Frame It** pack contains 2 bars which are to be mixed and matched with any other **You Frame It** sized bars to create a full frame.

The diagram below shows an example of how the sizes can be mixed and matched:



- **Lightweight frame system**
- **Easy to build, fold & lock**
- **Any size frame**
- **Creates perfect corners**
- **No warping unlike wooden frames**

With **You Frame It** it is possible to turn those spare material offcuts into unique pieces of modern wall art.

**You Frame It** is so versatile, it can be used with any of the following materials due to its unique stick and fold system:

- ✓ **Fabric**
- ✓ **PVC**
- ✓ **Paper**
- ✓ **Wallpaper**
- ✓ **Canvas**
- ✓ **Leather**

### what you need...

You only need the following items to create your **You Frame It** wall art, it's that simple!

- A piece of material  
*(at least 90mm bigger than your chosen frame size)*
- 2 x **You Frame It mix&match bar system** packs *(in any size)*
- Craft knife or good quality scissors

## assembly guide



## pack contents

- 1 2 x Aluminium YouFrame® Bars
- 2 2 x Plastic Tension Plates
- 3 4 x Plastic Universal Bar Corners
- 4 2 x Plastic Corner Clips

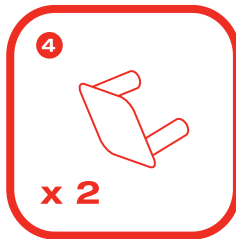
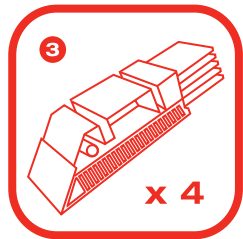
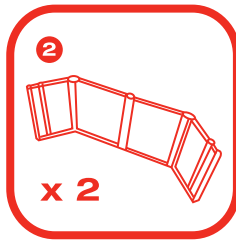
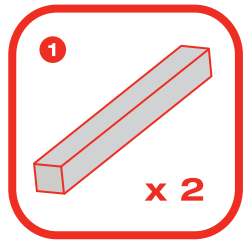

## assembly guide

For video and build tutorials visit  
[www.you-frame.com](http://www.you-frame.com)

### PLEASE READ FULLY THE FOLLOWING STEPS BEFORE ASSEMBLING THE FRAME:

- 1 Insert the plastic universal corners into each aluminium bar (8 corners in total with 2 packs). Apply tape along each bar where indicated\*  
*\*Unless otherwise pre-assembled.*
- 2 Lock the bars together by inserting the plastic tension plates into the grooves of the plastic corners to set the correct frame proportions.
- 3 Remove the tape backing along each bar and position the frame centrally on your chosen piece of material (allowing at least 90mm excess). Once stuck in position, simply cut away any excess material along the edge of the bars with a craft knife or sharp scissors.
- 4 Make a diagonal cut in each corner of the material to within 2mm of where the plastic corners meet.
- 5 Fold each corner of material against the tape as firmly as you can.
- 6 Remove the tension plates and roll the bars towards each other forming the depth of the frame.
- 7 Place a clip into the locator holes in each plastic corner and clasp firmly together.
- 8 Finally slot the tension plates back into place to strengthen the frame and create tension.

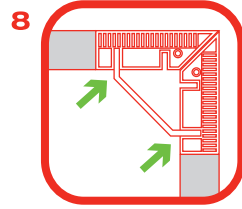
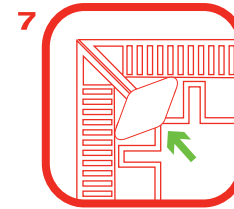
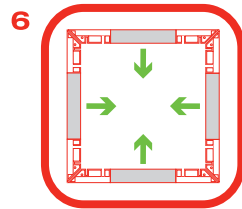
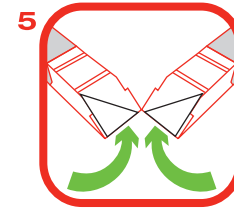
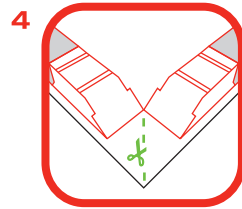
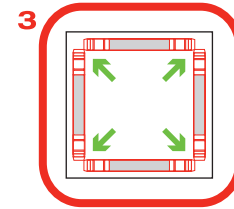
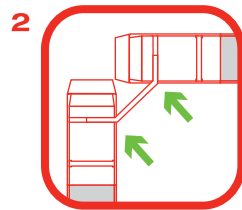
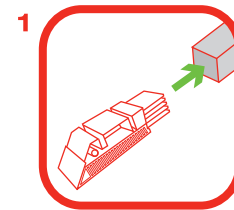

[www.you-frame.com](http://www.you-frame.com)

**You** frame®

YouFrame® is a registered trademark and is worldwide patent pending.